

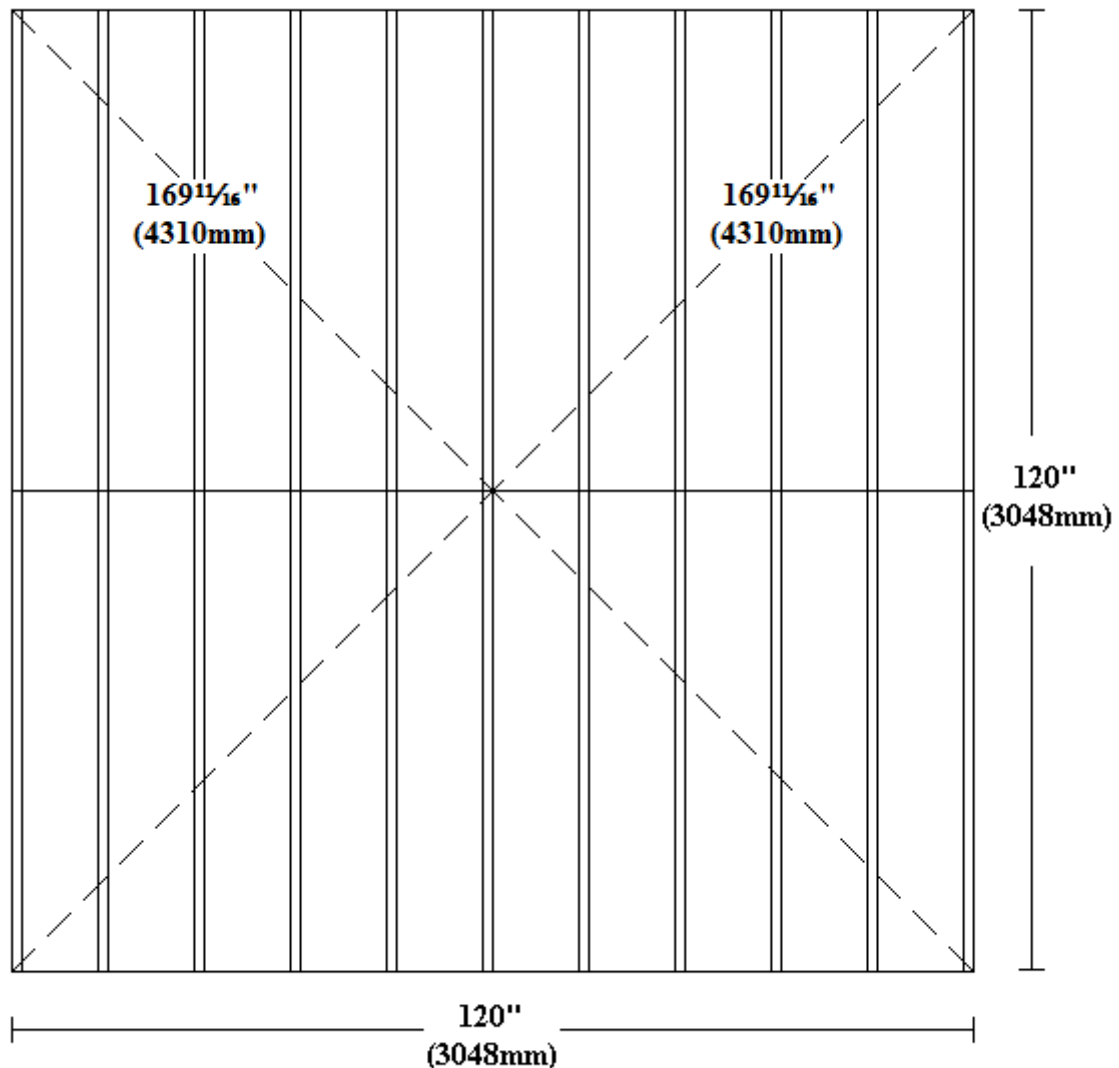

IMPORTANT: Please note that your Malvern Collection building requires a patio slab, concrete or timber decking foundation. It is important that the base is both firm and level, being either concrete, paving slabs or timber decking, all of which **must** be firm, level and completely cover the area of the base required, with **NO** fall for drainage, otherwise windows and doors may not operate correctly. A minimum clearance of 456mm (18") must be available ALL around the building for installation purposes.

3.05m x 3.05m (10' x 10') Base Plan



NB:- Floor joists run from gable to gable.